

Series S102/SX102

Panel mount displays for Profinet



The digital displays of the S102 and SX102 series are compact devices designed for installation in front panels or for switch panel mounting. The character height of the numeric version is 14 or 25 mm, of the alphanumeric version 18 or 30 mm.

Series S102

Units with numeric display

Standard units



Character height 14 mm	4 digits	6 digits
Type designation	S102-04/14/0x-000/0B-N0	S102-06/14/0x-000/0B-N0
Dimensional drawing	A	B



Character height 25 mm	4 digits	5 digits
Type designation	S102-04/25/0x-001/0B-N0	S102-05/25/0x-001/0B-N0
Dimensional drawing	C	C

Comfortable parameterization

The displays are fully parameterized with an engineering framework, for example Totally Integrated Automation (TIA) Siemens portal. This permits the parameterization even in build-in condition.

Integrated switch

The devices have two RJ45 sockets and an integrated IRT-ready switch in accordance with the conformance class CC-C.



Dimensional drawing A

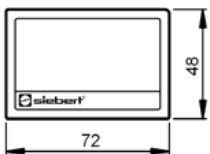

Dimensional drawing B

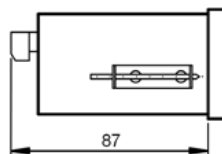
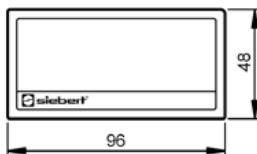

Dimensions in mm

Dimensional drawing C

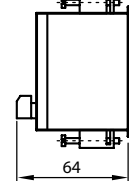
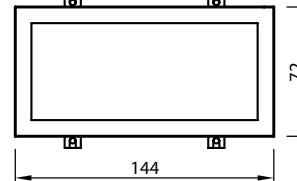

Extended character set

Among the digits the character set also contains the other letters and special characters which can be displayed with a 7-segment matrix.



Display overflow and underflow

If the display receives values which can not be displayed `uuuu` or `oooo` appears in the display.

Leading zeros

The numbers of the leading zeros can be set individually.

Unit conversion function

A formula, which can be stored in the display, allows the displaying of values in other measuring units, for example degrees Fahrenheit in degrees Celsius or kilograms to tons.



Dimension symbols

The shown dimension symbols are available.

F101	F102	F103	F120	F130	F141	F152	F161	F201	F202	F203	F210	F218	F220	F227	F235
g	kg	t	t/h	daN	l	l/s	ℓ	mm	cm	m	m ³	m/min	km/h	m/s	m ³ /min
F314	F324	F325	F331	F332	F402	F403	F404	F405	F406	F432	F440	F441	F443	F444	F476
kA	kW	MW	kWh	MWh	s	min	h	1/min	Stk.	%	°C	ppm	mbar	bar	mmWS



Smart-Dot-Function

If the Smart-Dot-Function is activated the display moves the decimal point automatically, so that the value before decimal point is automatically displayed. The decimal places are either truncated or rounded.

To display a date or a code several decimal points can be displayed also.



LED color

Red S102-xx/xx/xR-xxx/xx-xx
Green S102-xx/xx/xG-xxx/xx-x

Different presentational attribute

Values can be displays left-justified or right-justified. There are also different flashing modes to choose.

An automatic change in presentation is possible as well as when exceeding two threshold values or when falling below two threshold values. If for example the limit value is exceeded the value is flashing in the display. When the value returns to a value within the threshold the value shines permanently on the display again.

Technical data

Power supply 24 V DC $\pm 15\%$, galvanically isolated, protected against reversed polarity

Protection type IP40 front, optional IP65 (housing 72 x 48 and 96 x 48 mm)
IP65 front (housing 144 x 72 mm)

Connecting technology 2 x RJ45 socket, PROFINET conformance class CC-C

Detailed technical data see operating instructions.

Options

Protection type IP65 front¹ S102-xx/xx/xx-xx1/xx-xx
Dimension symbols S102-Fx/xx/xx-xxx/xx-xx

¹ Applies to S102-xx/14/xx-xxx/xx-xx

Series SX102

Displays for alphanumeric character representation

Standard units





Character height 18 mm	6 characters	8 characters	14 characters
Type designation	SX102-06/18/0x-000/0B-N0	SX102-08/18/0x-001/0B-N0	SX102-14/18/0x-001/0B-N0
Dimensional drawing	B	C	D



Character height 30 mm	8 characters
Type designation	SX102-08/30/0x-001/0B-N0
Dimensional drawing	D

Dimensional drawing B

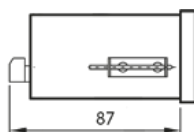
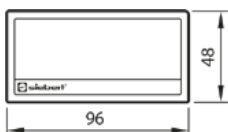

Dimensional drawing C



Dimensional drawing D

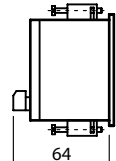
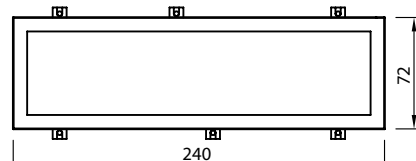

Dimensions in mm



Comfortable parameterization

The displays are fully parameterized with an engineering framework, for example Totally Integrated Automation (TIA) Siemens portal. This permits the parameterization even in mounted condition.



Integrated switch

The devices have two RJ45 sockets and an integrated IRT-ready switch in accordance with the conformance class CC-C.

Different presentational attribute

Values can be displays left-justified or right-justified. There are also different flashing modes to choose.

Technical data

Power supply	24 V DC $\pm 15\%$, galvanically isolated, protected against reversed polarity
Protection type	IP40 front, optional IP65 (housing 96 x 48 mm) IP65 front (housing 144 x 72 and 240 x 72 mm)
Connecting technology	2 x RJ45 socket, PROFINET conformance class CC-C
Detailed technical data see operating instructions.	

Options

Protection type IP65 front ¹	SX102-xx/xx/xx-xx1/xx-xx
¹ Applies to SX102-06/18/xx-xxx/xx-xx	

www.siebert-group.com

GERMANY

Siebert Industrieelektronik GmbH
Siebertstrasse
D-66571 Eppelborn
Phone +49 6806 980-0
Fax +49 6806 980-999
info.de@siebert-group.com

FRANCE

Siebert France Sarl
4 rue de l'Abbé Louis Verdet
F-57200 Sarreguemines
Phone +33 3 87 98 63 68
Fax +33 3 87 98 63 94
info.fr@siebert-group.com

ITALY

Siebert Italia Srl
Via Galileo Galilei 2/A
I-39100 Bolzano (BZ)
Phone +39 0471 053 753
Fax +39 0471 053 754
info.it@siebert-group.com

THE NETHERLANDS

Siebert Nederland B.V.
Jadedreef 26
NL-7828 BH Emmen
Phone +31 591 633 444
Fax +31 591 633 125
info.nl@siebert-group.com

AUSTRIA

Siebert Österreich GmbH
Simmeringer Hauptstrasse 24
A-1110 Wien
Phone +43 1 740 401 53
info.at@siebert-group.com

SWITZERLAND

Siebert AG
Bützbergstrasse 2
CH-4912 Aarwangen
Phone +41 62 922 18 70
Fax +41 62 922 33 37
info.ch@siebert-group.com

INTERNATIONAL

Argentina, Australia, China, Colombia, Czech Republic, Denmark, Estonia, Finland, Hong Kong, Iceland, India, Israel, Korea, Malaysia, Mexico, Norway, Poland, Singapore, Slovenia, South Africa, Spain, Turkey, United Kingdom

Siebert®, LRD® and XC-Board® are registered trademarks of Siebert Industrieelektronik GmbH. All other product names mentioned herein may be trademarks or registered trademarks of their respective owners. All information and data included in this documentation is provided without guarantee and is subject to change at any time without prior notification. All illustrations shall be without obligation and cannot be considered binding. The products shown may contain optional equipment. Availability and technical specifications are subject to change without prior notice. All rights to this documentation are reserved. Our current terms and conditions of sale and delivery apply exclusively (see www.siebert-group.com, available upon request). 01-10.02.EN.0301